

Molinar - Palma

Unique terraced houses with pool and sea views in Molinar

Property ID: ES253745537_21



PURCHASE PRICE: 2.700.000 EUR • LIVING SPACE: ca. 131 m² • ROOMS: 4 • LAND AREA: 110 m²

Property ID: ES253745537_21 - 07006 Molinar - Palma

- **At a glance**
- **The property**
- **Energy Data**
- **Floor plans**
- **A first impression**
- **Details of amenities**
- **All about the location**
- **Other information**
- **Contact partner**

Property ID: ES253745537_21 - 07006 Molinar - Palma

At a glance

Property ID	ES253745537_21	Purchase Price	2.700.000 EUR
Living Space	ca. 131 m ²	House	Terrace house
Rooms	4	Condition of property	Projected
Bedrooms	3	Construction method	Solid
Bathrooms	2	Equipment	Terrace, Swimming pool, Built-in kitchen

Property ID: ES253745537_21 - 07006 Molinar - Palma

Energy Data

Type of heating	Underfloor heating
Energy information	At the time of preparing the document, no energy certificate was available.

Property ID: ES253745537_21 - 07006 Molinar - Palma

The property



Property ID: ES253745537_21 - 07006 Molinar - Palma

The property



Property ID: ES253745537_21 - 07006 Molinar - Palma

The property



Property ID: ES253745537_21 - 07006 Molinar - Palma

The property



Property ID: ES253745537_21 - 07006 Molinar - Palma

The property



Property ID: ES253745537_21 - 07006 Molinar - Palma

The property



Property ID: ES253745537_21 - 07006 Molinar - Palma

The property



Property ID: ES253745537_21 - 07006 Molinar - Palma

The property

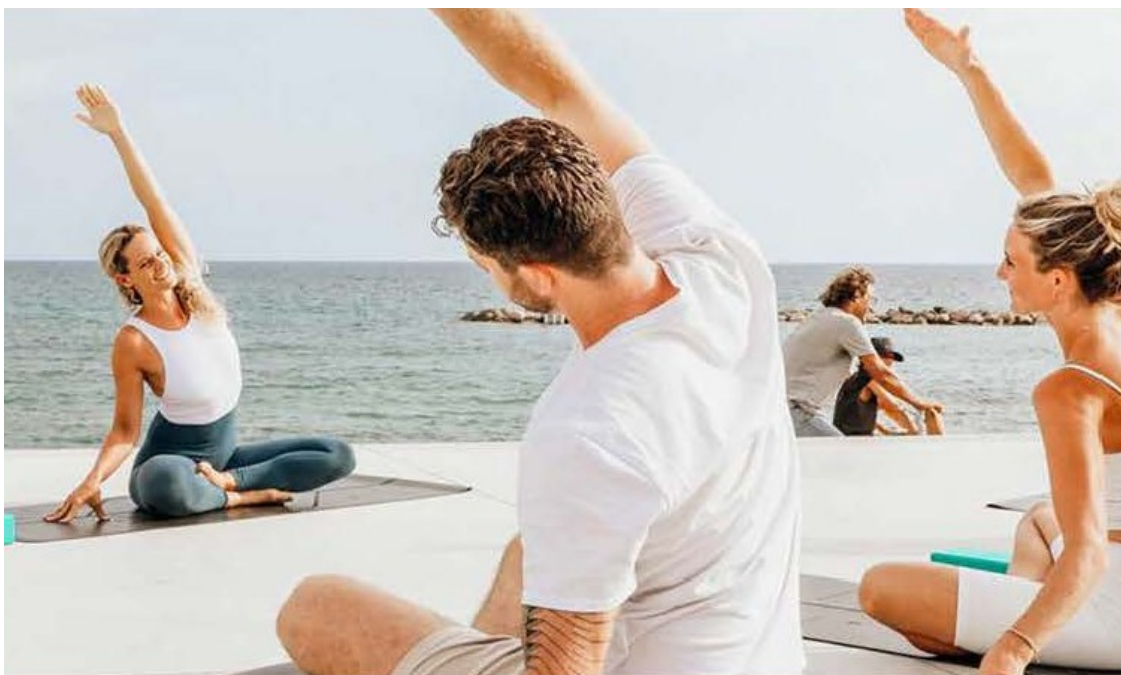

Property ID: ES253745537_21 - 07006 Molinar - Palma

The property

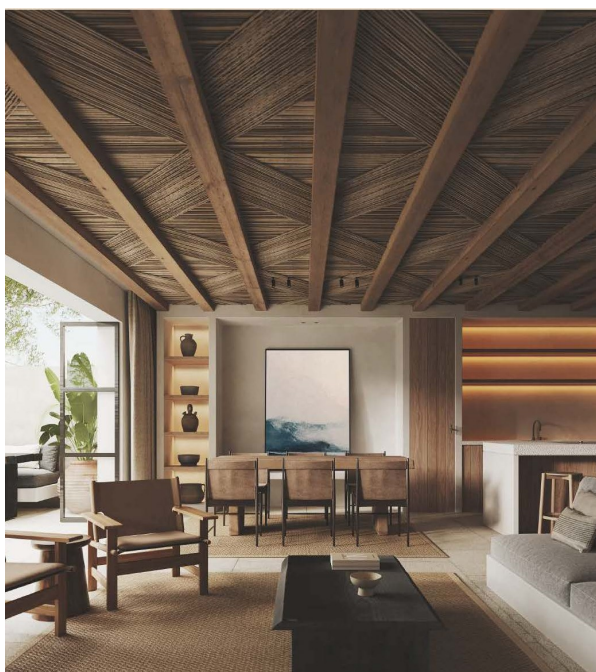

Property ID: ES253745537_21 - 07006 Molinar - Palma

The property



Property ID: ES253745537_21 - 07006 Molinar - Palma

The property



Property ID: ES253745537_21 - 07006 Molinar - Palma

The property



Property ID: ES253745537_21 - 07006 Molinar - Palma

The property



Property ID: ES253745537_21 - 07006 Molinar - Palma

The property



Property ID: ES253745537_21 - 07006 Molinar - Palma

The property



Property ID: ES253745537_21 - 07006 Molinar - Palma

The property



Property ID: ES253745537_21 - 07006 Molinar - Palma

The property



Property ID: ES253745537_21 - 07006 Molinar - Palma

Floor plans

CONSTRUCTED AREA OF EACH PROPERTY

Interior** + Exterior**

Residence 1	Off Market
Residence 2	152,81 m ² + 98,4 m ²
Residence 3	152,81 m ² + 98,4 m ²
Residence 4	152,81 m ² + 98,4 m ²
Residence 5	152,81 m ² + 98,4 m ²
Residence 6	152,81 m ² + 98,4 m ²
Residence 7	152,81 m ² + 98,4 m ²
Residence 8	152,81 m ² + 98,4 m ²
Residence 9	219,21 m ² + 189,85 m ²
Residence 10	Off Market
Residence 11	147,19 m ² + 60,43 m ²
Residence 12	143,65 m ² + 77,21 m ²
Residence 13	143,65 m ² + 96,37 m ²
Residence 14	143,65 m ² + 62,01 m ²
Residence 15	152,74 m ² + 66,26 m ²
Residence 16	145,70 m ² + 66,18 m ²
Residence 17	154,75 m ² + 59,49 m ²
Residence 18	200,37 m ² + 82,29 m ²
Residence 19	141,00 m ² + 52,48 m ²
Residence 20	131,64 m ² + 49,40 m ²
Residence 21	131,42 m ² + 49,37 m ²

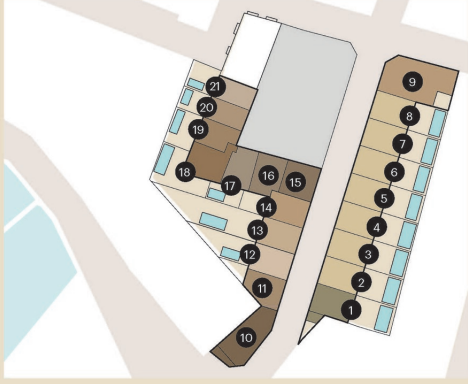

*Interior enclosed built-up area, garage space not included.
**Exterior built-up area, all terraces and roof-top terrace.

SUPERFICIE CONSTRUIDA 131,42 m²
 SUPERFICIE INTERIOR DESTINADA
 49,37 m²
 SUPERFICIE EXTERIOR DESTINADA
 82,05 m²

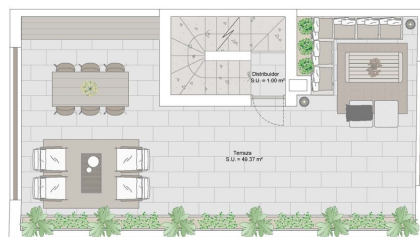

SUPERFICIE CONSTRUIDA 131,42 m²
***Exterior built-up areas, all terraces and roof-top terrace.

SUPERFICIE INTERIOR ESTACIONG

SE_ABL/TERRASA	12,02
SE_BED	12,02
SE_BORNO/BAÑO/COMEDOR	43,22
SE_COCINA	30,11
SE_PORCH	34,44
SE_POOL	9,61



SUPERFICIE CONSTRUIDA 131,42 m²
***Exterior built-up areas, all terraces and roof-top terrace.

SUPERFICIE INTERIOR ESTACIONG

SE_BED	12,02
SE_BORNO/BAÑO	12,02
SE_BED	12,02
SE_BORNO/BAÑO	12,02
SE_BORNO/BAÑO	12,02
SE_BORNO/BAÑO	12,02

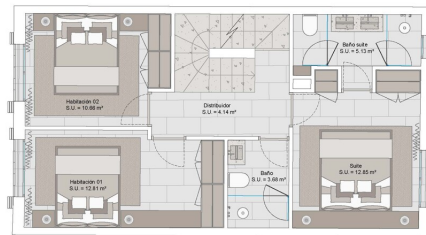

CONSTRUCTED AREA
OF EACH PROPERTY

	Interior* + Exterior**
Residence 1	Off Market
Residence 2	152,81 m ² + 98,4 m ²
Residence 3	152,81 m ² + 98,4 m ²
Residence 4	152,81 m ² + 98,4 m ²
Residence 5	152,81 m ² + 98,4 m ²
Residence 6	152,81 m ² + 98,4 m ²
Residence 7	152,81 m ² + 98,4 m ²
Residence 8	152,81 m ² + 98,4 m ²
Residence 9	219,21 m ² + 189,85 m ²
Residence 10	Off Market
Residence 11	147,19 m ² + 60,43 m ²
Residence 12	143,65 m ² + 77,21 m ²
Residence 13	143,65 m ² + 96,37 m ²
Residence 14	143,65 m ² + 62,01 m ²
Residence 15	152,74 m ² + 66,26 m ²
Residence 16	145,70 m ² + 66,18 m ²
Residence 17	154,75 m ² + 59,49 m ²
Residence 18	200,37 m ² + 82,29 m ²
Residence 19	141,00 m ² + 52,48 m ²
Residence 20	131,64 m ² + 49,40 m ²
Residence 21	131,42 m ² + 49,37 m ²

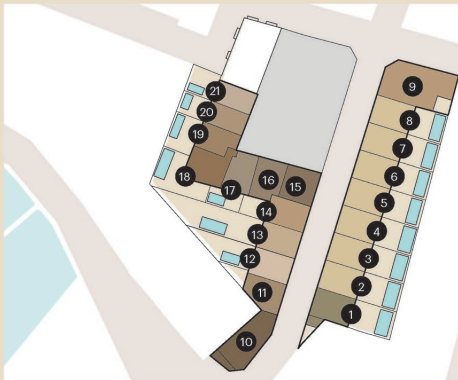

*Interior enclosed built-up areas, garage space not included.
 **Exterior built-up areas, all terraces and roof-top terrace.

SUPERFICIE CONSTRUIDA		131.47 m ²
<small>El área construida incluye el área de terraza</small>		
SUPERFICIE INTERIOR ESTACIONES		
RF_01000	...	43.37 m ²
RF_020000	...	1.88 m ²

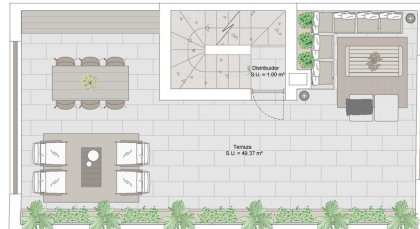

SUPERFICIE CONSTRUIDA		131.47 m ²
<small>El área construida incluye el área de terraza</small>		
SUPERFICIE INTERIOR ESTACIONES		
RF_01000	...	3.00 m ²
RF_020	...	4.30 m ²
RF_030000 (SALA COMEDOR)	...	43.37 m ²
RF_0400	...	31.11 m ²
RF_0500	...	33.64 m ²
RF_0600	...	5.07 m ²



SUPERFICIE CONSTRUIDA		131.47 m ²
<small>El área construida incluye el área de terraza</small>		
SUPERFICIE INTERIOR ESTACIONES		
RF_010	...	5.07 m ²
RF_020 (SALA)	...	33.34 m ²
RF_030	...	31.11 m ²
RF_040000 (S)	...	5.07 m ²
RF_050000 (S)	...	33.64 m ²
RF_060000	...	4.30 m ²

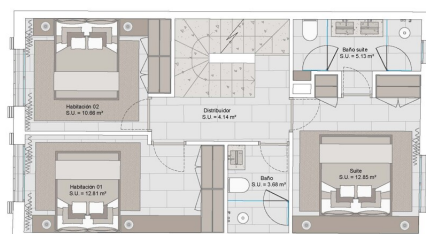

This floor plan is not to scale. The documents were given to us by the client. For this reason, we cannot guarantee the accuracy of the information.

Property ID: ES253745537_21 - 07006 Molinar - Palma

A first impression

In one of Palma's most sought-after locations, in the charming El Molinar district, a luxurious residential complex is being built with 21 exclusive homes that blend harmoniously into the Mediterranean surroundings thanks to their clear architecture and the use of the finest materials. The color scheme of white, warm wood tones and natural stone reflects the island's typical character and lends the complex a timeless elegance that blends seamlessly into the flair of this unique coastal resort. Just a few steps from the sea, an incomparable lifestyle unfolds here, characterized by the gentle sea breeze, the authentic charm of the historic fishing district and the creative atmosphere that has always inspired artists, writers and free spirits.

The houses extend over two levels and also offer a Mediterranean garden and a roof terrace with breathtaking views of the Mediterranean. High-quality natural stone floors lend the interiors a cool elegance, while custom-made fitted wardrobes in natural oak add a warm yet timeless touch. Each home comprises three double bedrooms, three stylish bathrooms and a separate guest WC. Almost all units have their own patio with private pool and direct access to the garage, guaranteeing privacy and comfort at the highest level.

Completion of the development is scheduled for the second quarter of 2027. Until then, the architectural renderings already give an impression of the exceptional quality and sophisticated design.

This project combines Mediterranean lightness with modern luxury - an exceptional home in one of Mallorca's most valuable locations.

Property ID: ES253745537_21 - 07006 Molinar - Palma

Details of amenities

- Stone façade with thermal insulation, natural wood cladding on the interior walls
- pool
- garden
- Natural stone floor
- Double-glazed windows with aluminum frames and wooden blinds
- Underfloor heating
- Water softening and osmosis system
- KNX-Domotic home control system
- GAGGENAU kitchen appliances
- Roof terrace of approx. 49 m²

Property ID: ES253745537_21 - 07006 Molinar - Palma

All about the location

El Molinar, a former fishing and artisan quarter on the eastern outskirts of Palma, has developed into one of Mallorca's most sought-after residential areas in recent years. With around 9,000 inhabitants, this charming coastal town combines the maritime flair of a traditional harbor district with the urban comfort of the nearby island capital. The waterfront promenade with its small sandy coves, colorful fishermen's houses and excellent restaurants gives Molinar an unmistakable character that is both authentic and modern. The history of the district dates back to the 19th century, when numerous windmills stood here, giving the place its name, and the original charm can still be felt today. The location could hardly be more ideal. Palma is just a few minutes away, the international airport can be reached in less than 10 kilometers and there are direct links along the coast to Can Pastilla, Portixol and Playa de Palma. The neighborhood boasts a quiet, family-friendly atmosphere, while the vibrant old town of Palma, with its cultural offerings, exclusive boutiques and international schools, is just a short distance away. For sports and leisure enthusiasts, Molinar offers a wide range of possibilities. Sailing, surfing, stand-up paddling or simply a stroll along the kilometer-long beach promenade are part of everyday life. Cyclists and joggers appreciate the direct connection to the historic center of Palma, while golfers enjoy the proximity to first-class courses such as Golf Son Vida, Golf Puntiró or Golf Maioris. The beaches on the doorstep invite you to spend relaxing days by the sea, and numerous beach clubs and restaurants ensure Mediterranean joie de vivre at the highest level. Molinar is therefore not just a place to live, but a way of life - a perfect symbiosis of Mallorcan tradition, urban lifestyle and exclusive coastal location, making it one of the most sought-after locations for a stylish home on the island.

Property ID: ES253745537_21 - 07006 Molinar - Palma

Other information

We generally recommend having the building law situation checked by a specialist lawyer. All details are based exclusively on information provided by the owner or client. We assume no liability for the completeness, accuracy and timeliness of the information. The brokerage fee is payable by the vendor. Any taxes, notary and land registry costs incurred on the purchase are to be borne by the buyer.

Property ID: ES253745537_21 - 07006 Molinar - Palma

Contact partner

For further information, please contact your contact person:

Florian Waetzoldt

Placa Hostals 11, 07320 Santa Maria del Camí

Tel.: +34 871 - 201 945

E-Mail: santamaria@von-poll.com

To the Disclaimer of von Poll Immobilien GmbH

www.von-poll.com