

Vignanello - Toscana

# Prestigious historic farmhouse in the heart of Tuscia

Property ID: IT262943106



[www.von-poll.it](http://www.von-poll.it)

**PURCHASE PRICE: 545.000 EUR • ROOMS: 14 • LAND AREA: 2.200 m<sup>2</sup>**

**Property ID: IT262943106 - 01039 Vignanello - Toscana**

- **At a glance**
- **The property**
- **Energy Data**
- **Floor plans**
- **A first impression**
- **Contact partner**

**Property ID: IT262943106 - 01039 Vignanello - Toscana**

## At a glance

<b>Property ID</b>	<b>IT262943106</b>	<b>Purchase Price</b>	<b>545.000 EUR</b>
<b>Rooms</b>	<b>14</b>	<b>House</b>	<b>Single-family house / Detached house</b>
<b>Bathrooms</b>	<b>4</b>	<b>Total Space</b>	<b>ca. 344 m<sup>2</sup></b>
<b>Year of construction</b>	<b>1984</b>	<b>Equipment</b>	<b>Terrace</b>

Property ID: IT262943106 - 01039 Vignanello - Toscana

## Energy Data

Power Source	Gas
Energy information	At the time of preparing the document, no energy certificate was available.

Property ID: IT262943106 - 01039 Vignanello - Toscana

## The property



Property ID: IT262943106 - 01039 Vignanello - Toscana

## The property



Property ID: IT262943106 - 01039 Vignanello - Toscana

## The property



Property ID: IT262943106 - 01039 Vignanello - Toscana

## The property



Property ID: IT262943106 - 01039 Vignanello - Toscana

## The property



Property ID: IT262943106 - 01039 Vignanello - Toscana

## The property



Property ID: IT262943106 - 01039 Vignanello - Toscana

## The property



Property ID: IT262943106 - 01039 Vignanello - Toscana

## The property



Property ID: IT262943106 - 01039 Vignanello - Toscana

## The property



Property ID: IT262943106 - 01039 Vignanello - Toscana

## The property



Property ID: IT262943106 - 01039 Vignanello - Toscana

## The property



Property ID: IT262943106 - 01039 Vignanello - Toscana

## The property



Property ID: IT262943106 - 01039 Vignanello - Toscana

## The property



Property ID: IT262943106 - 01039 Vignanello - Toscana

## The property



Property ID: IT262943106 - 01039 Vignanello - Toscana

## The property



Property ID: IT262943106 - 01039 Vignanello - Toscana

## The property



[www.von-poll.it](http://www.von-poll.it)



Property ID: IT262943106 - 01039 Vignanello - Toscana

## The property



Property ID: IT262943106 - 01039 Vignanello - Toscana

## The property



Property ID: IT262943106 - 01039 Vignanello - Toscana

## The property



Property ID: IT262943106 - 01039 Vignanello - Toscana

## The property



Property ID: IT262943106 - 01039 Vignanello - Toscana

## The property



Property ID: IT262943106 - 01039 Vignanello - Toscana

## The property



Property ID: IT262943106 - 01039 Vignanello - Toscana

## The property



Property ID: IT262943106 - 01039 Vignanello - Toscana

## The property



Property ID: IT262943106 - 01039 Vignanello - Toscana

## The property



Property ID: IT262943106 - 01039 Vignanello - Toscana

## The property



Property ID: IT262943106 - 01039 Vignanello - Toscana

## The property



Property ID: IT262943106 - 01039 Vignanello - Toscana

## The property



Property ID: IT262943106 - 01039 Vignanello - Toscana

## The property



Property ID: IT262943106 - 01039 Vignanello - Toscana

## The property



Property ID: IT262943106 - 01039 Vignanello - Toscana

## The property



Property ID: IT262943106 - 01039 Vignanello - Toscana

## Floor plans

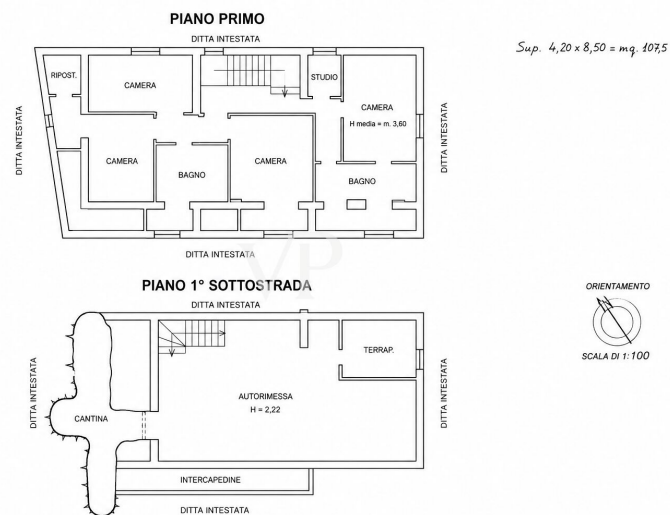
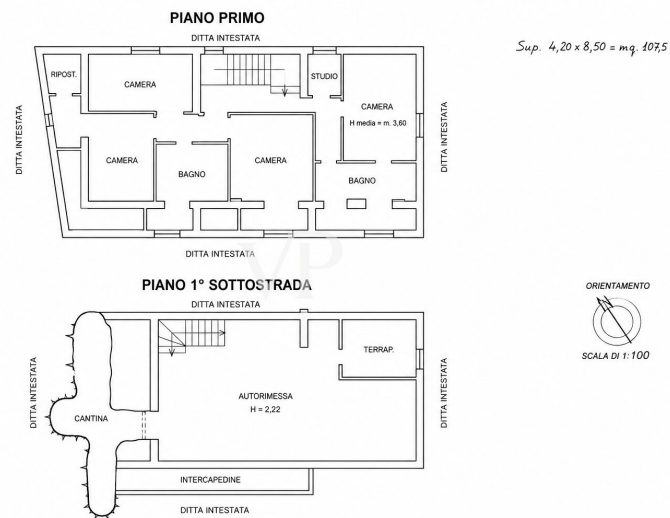

This floor plan is not to scale. The documents were given to us by the client. For this reason, we cannot guarantee the accuracy of the information.

**Property ID: IT262943106 - 01039 Vignanello - Toscana**

## **A first impression**

Nestled in the green heart of Tuscany, within the charming village of Vignanello, renowned for the historic Castello Ruspoli and its remarkable Renaissance gardens, this magnificent traditional tuff farmhouse offers a rare opportunity to experience authentic Italian country living in one of Central Italy's most enchanting and undiscovered regions.

Set in a privileged position adjacent to the castle gardens, the property enjoys a unique setting where history, nature and architectural heritage blend harmoniously. A picturesque tree-lined avenue, framed by ancient cypress trees and majestic pines, leads to the estate, surrounded by approximately 2,200 sqm of private parkland featuring centuries-old olive trees, ornamental plants and a historic well that preserves the timeless character of the property.

The farmhouse extends over approximately 344 sqm across three levels. The interiors are bright and welcoming, centred around a spacious living room distinguished by elegant arches, a traditional stone fireplace and authentic architectural details that reflect the rich rural heritage of the region.

The kitchen combines rustic charm with functionality and enjoys pleasant views over the surrounding greenery, while the bedrooms offer peaceful and intimate spaces designed for comfort and relaxation. Every room conveys the warmth and authenticity of a traditional country residence, perfectly suited for both family life and entertaining guests.

Further enhancing the property's appeal are several distinctive features, including a spacious cellar ideal for wine storage, an ancient grotto that adds character and uniqueness to the estate, and a charming tavern with fireplace, creating the perfect setting for convivial gatherings throughout the year.

Located only one hour from Rome, within a landscape rich in medieval villages, vineyards, historic gardens and unspoiled countryside, this exceptional property represents an exclusive retreat where elegance, authenticity and nature coexist in perfect balance. It offers not simply a home, but a lifestyle deeply connected to the beauty, history and traditions of Tuscany's neighbouring Tuscia region.

**Property ID: IT262943106 - 01039 Vignanello - Toscana**

## Contact partner

**For further information, please contact your contact person:**

**Christian Weissensteiner**

---

**Corso Italia 1, 20122 Milano**

**Tel.: +39 02 6206 9360**

**E-Mail: [milano@von-poll.com](mailto:milano@von-poll.com)**

*To the Disclaimer of von Poll Immobilien GmbH*

---

**[www.von-poll.com](http://www.von-poll.com)**