

Sineu - Mitte

Luxurious fully renovated house with pool in Sineu, Mallorca

Property ID: ES265815



PURCHASE PRICE: 2.590.000 EUR • LIVING SPACE: ca. 393 m² • ROOMS: 6 • LAND AREA: 289 m²

Property ID: ES265815 - 07510 Sineu - Mitte

- At a glance
- The property
- Energy Data
- A first impression
- Details of amenities
- All about the location
- Other information
- Contact partner

Property ID: ES265815 - 07510 Sineu - Mitte

At a glance

Property ID	ES265815	Purchase Price	2.590.000 EUR
Living Space	ca. 393 m ²	Condition of property	Completely renovated
Rooms	6	Equipment	Terrace, Guest WC, Swimming pool, Fireplace
Bedrooms	4		
Bathrooms	5		
Year of construction	1925		
Type of parking	1 x Other		

Property ID: ES265815 - 07510 Sineu - Mitte

Energy Data

Type of heating	Central heating
Energy information	At the time of preparing the document, no energy certificate was available.

Property ID: ES265815 - 07510 Sineu - Mitte

The property



Property ID: ES265815 - 07510 Sineu - Mitte

The property



Property ID: ES265815 - 07510 Sineu - Mitte

The property



Property ID: ES265815 - 07510 Sineu - Mitte

The property

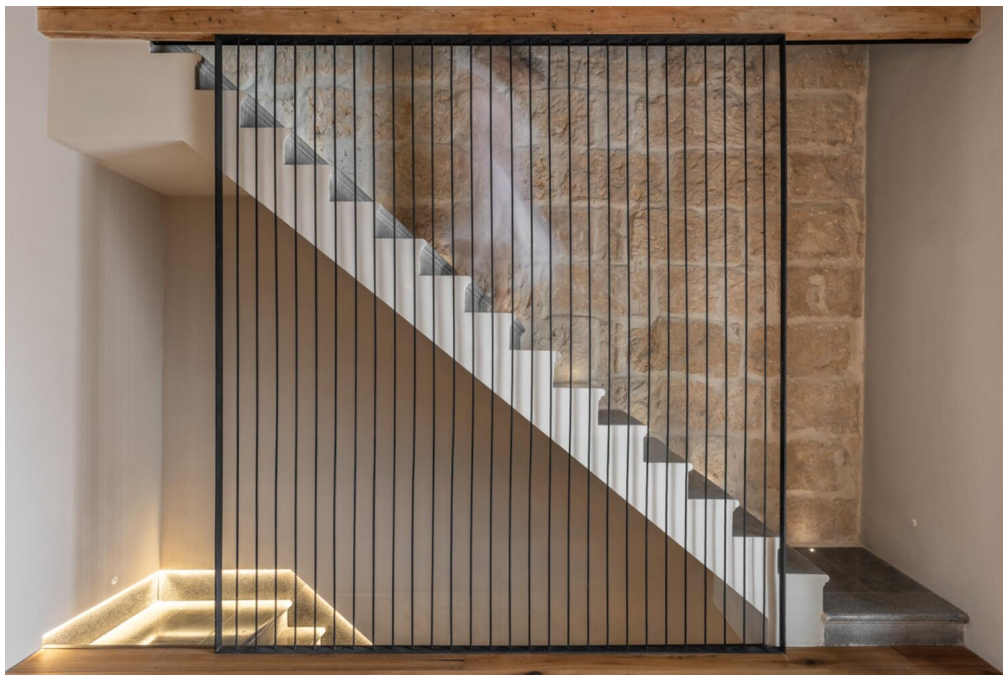

Property ID: ES265815 - 07510 Sineu - Mitte

The property



Property ID: ES265815 - 07510 Sineu - Mitte

The property



Property ID: ES265815 - 07510 Sineu - Mitte

The property



Property ID: ES265815 - 07510 Sineu - Mitte

The property



Property ID: ES265815 - 07510 Sineu - Mitte

The property



Property ID: ES265815 - 07510 Sineu - Mitte

The property



Property ID: ES265815 - 07510 Sineu - Mitte

The property



Property ID: ES265815 - 07510 Sineu - Mitte

A first impression

Located on a quiet street in the heart of Sineu, just a few minutes from the town's well-known main square, this impressive village house stands out for its elegance, character and prime location.

Originally built in 1925 and fully renovated in 2025, the property perfectly combines traditional Mallorcan architecture with a carefully curated contemporary design. Original features such as natural stone arches blend seamlessly with modern finishes, creating a home with a strong and distinctive identity.

The harmonious contrast between the refined, modern interiors and the historic façade results in a unique residence, ready to move into and enjoy from day one.

Distributed over three levels, the property currently offers three generously sized bedrooms, with the possibility of creating an additional fourth bedroom. All bedrooms feature en-suite bathrooms, ensuring a high level of comfort and privacy. Abundant natural light, together with thoughtfully designed ambient lighting, creates a warm and welcoming atmosphere throughout the home.

One of the property's main highlights is its outdoor area, designed for year-round enjoyment. A charming inner patio with terrace and a stunning swimming pool provides the perfect setting for social gatherings or moments of relaxation. A chill-out area and landscaped garden space further enhance the sense of tranquility and wellbeing.

The house also benefits from access from two streets and a spacious garage with parking for one vehicle and additional storage space — a rare feature in Sineu's historic centre.

Additional features include electric underfloor heating in the bathrooms, ducted air conditioning with heat pump, mains water and electricity, parquet, marble and tiled floors, fireplace, full climate control, furnished interiors, guest toilet and high-quality finishes throughout.

An exceptional residence in the heart of Mallorca, where tradition and contemporary design come together to offer a truly unique lifestyle.

Property ID: ES265815 - 07510 Sineu - Mitte

Details of amenities

- Guest bathroom
- Marble, tile, and parquet floors
- Fireplace
- Air conditioning
- Terrace
- Balcony
- Swimming pool
- Central heating

Property ID: ES265815 - 07510 Sineu - Mitte

All about the location

Sineu is located in the centre of Mallorca and forms part of the island's historical and cultural region known as the Pla de Mallorca. It benefits from a railway connection via the Palma–Manacor line and preserves a strong agricultural tradition, reflected in its famous weekly Wednesday market and annual fair. Its main square, Plaça des Fossar, lined with cafés and terraces, is the perfect place to enjoy the peaceful and authentic atmosphere of this charming Mallorcan village.

Property ID: ES265815 - 07510 Sineu - Mitte

Other information

We generally recommend that you have the building law situation checked by a specialist lawyer. All details are based exclusively on the information provided by the owner or client. We assume no liability for the completeness, accuracy and timeliness of the information. The brokerage fee is payable by the vendor. Any taxes, notary and land registry costs incurred on the purchase are to be borne by the buyer.

Property ID: ES265815 - 07510 Sineu - Mitte

Contact partner

For further information, please contact your contact person:

Christian W. Czarnetzki

C./Cecilio Metelo 67, E-07460 Pollensa

Tel.: +34 971 530 088

E-Mail: pollensa@von-poll.com

To the Disclaimer of von Poll Immobilien GmbH

www.von-poll.com