

Leudelange - Lux périphérie Ouest

## Office space for rent

*Property ID: LU881800069\_1*



**RENT PRICE: 0 EUR**

**Property ID: LU881800069\_1 - L-3364 Leudelange - Lux périphérie Ouest**

- **At a glance**
- **The property**
- **Floor plans**
- **A first impression**
- **Contact partner**

Property ID: LU881800069\_1 - L-3364 Leudelange - Lux périphérie Ouest

## At a glance

Property ID	LU881800069_1	Rent price	On request
Available from	29.04.2019	Commission	Fees paid by the owner
Floor	2	Total Space	ca. 686 m <sup>2</sup>
Type of parking	20 x Underground car park		

Property ID: LU881800069\_1 - L-3364 Leudelange - Lux périphérie Ouest

## The property



Property ID: LU881800069\_1 - L-3364 Leudelange - Lux périphérie Ouest

## The property



Property ID: LU881800069\_1 - L-3364 Leudelange - Lux périphérie Ouest

## Floor plans

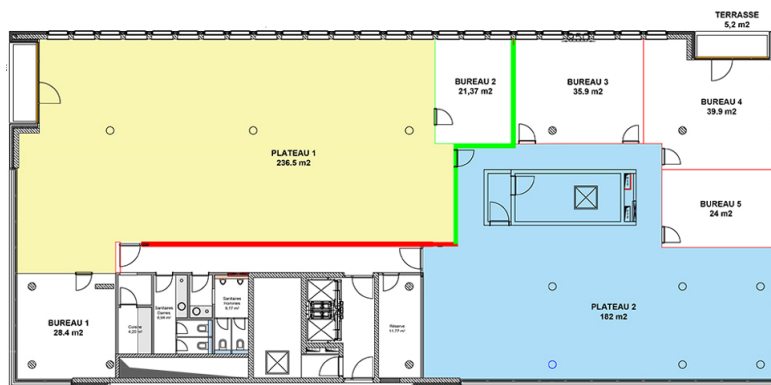

This floor plan is not to scale. The documents were given to us by the client. For this reason, we cannot guarantee the accuracy of the information.

**Property ID: LU881800069\_1 - L-3364 Leudelange - Lux périphérie Ouest**

## **A first impression**

**Recent office building with good visibility.**

**They consist of 2 fully equipped trays of 686 m<sup>2</sup> each, on the 2nd and 3rd floor of the building.**

**The surfaces are composed of open space, partitioned offices, toilets, kitchenette, IT room.**

**Close to all amenities. Highway axes nearby.**

Property ID: LU881800069\_1 - L-3364 Leudelange - Lux périphérie Ouest

## Contact partner

For further information, please contact your contact person:

VON POLL REAL ESTATE Limpertsberg

---

6, avenue Pasteur, L-2310 Luxembourg

**Tel.:** +352 26 47 98

**E-Mail:** [limpertsberg@von-poll.com](mailto:limpertsberg@von-poll.com)

*To the Disclaimer of von Poll Immobilien GmbH*

---

[www.von-poll.com](http://www.von-poll.com)