

Luxembourg-Limpertsberg – Luxembourg-Limpertsberg

# Furnished 1 bedroom top floor apartment for sale in Limpertsberg

Property ID: LU160001455



PURCHASE PRICE: 695.000 EUR • LIVING SPACE: ca. 55,24 m<sup>2</sup>

Property ID: LU160001455 - L-1856 Luxembourg-Limpertsberg – Luxembourg-Limpertsberg

- At a glance
- The property
- Energy Data
- Floor plans
- A first impression
- Other information
- Contact partner

Property ID: LU160001455 - L-1856 Luxembourg-Limpertsberg – Luxembourg-Limpertsberg

## At a glance

Property ID	LU160001455
Living Space	ca. 55,24 m²
Roof Type	Mansard roof
Available from	According to the arrangement
Floor	3
Bedrooms	1
Bathrooms	1

Purchase Price	695.000 EUR
Construction method	Solid
Usable Space	ca. 0 m²
Equipment	Built-in kitchen

Property ID: LU160001455 - L-1856 Luxembourg-Limpertsberg – Luxembourg-Limpertsberg

## Energy Data

Power Source

Gas

Property ID: LU160001455 - L-1856 Luxembourg-Limpertsberg – Luxembourg-Limpertsberg

## The property



Property ID: LU160001455 - L-1856 Luxembourg-Limpertsberg – Luxembourg-Limpertsberg

## The property

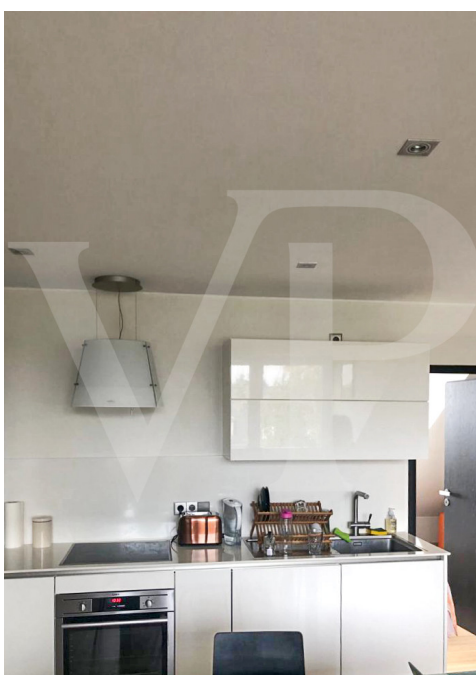

Property ID: LU160001455 - L-1856 Luxembourg-Limpertsberg – Luxembourg-Limpertsberg

## The property





Property ID: LU160001455 - L-1856 Luxembourg-Limpertsberg – Luxembourg-Limpertsberg

## The property





Property ID: LU160001455 - L-1856 Luxembourg-Limpertsberg – Luxembourg-Limpertsberg

## Floor plans

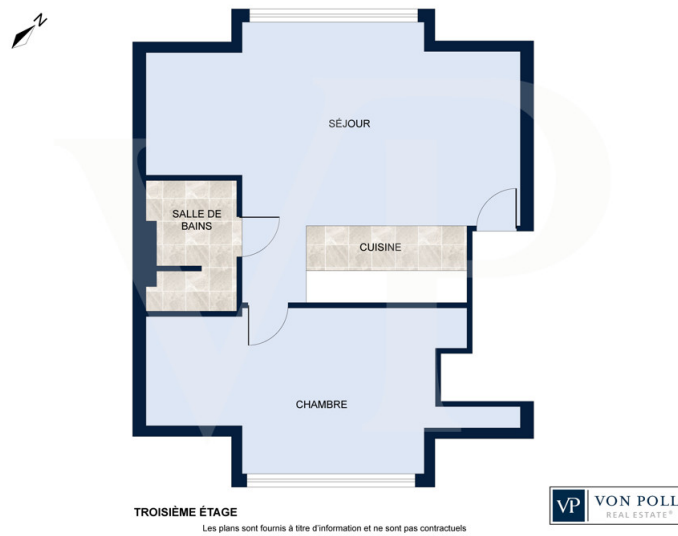

This floor plan is not to scale. The documents were given to us by the client. For this reason, we cannot guarantee the accuracy of the information.

Property ID: LU160001455 - L-1856 Luxembourg-Limpertsberg – Luxembourg-Limpertsberg

## A first impression

Von Poll offers you for sale this top floor of a recent building in Limpertsberg. This apartment located on the top floor enjoys a clear view of the Limpertsberg. It consists of 1 entrance hall opening onto the living room/lounge. The open kitchen offers beautiful light to the home. The shower room includes 1 sink, 1 toilet and 1 Italian shower. The large bedroom has clever storage. A cellar and a laundry room complete this property. Close to the city center, shops, transport, cinema, philharmonic and theater.

Property ID: LU160001455 - L-1856 Luxembourg-Limpertsberg – Luxembourg-Limpertsberg

## Other information

All indications in the present document are based exclusively on the information made available to us by our customers. We do not assume any guarantee as to the completeness, accuracy and timeliness of these indications. The notary fees and registration fees/stamp duties at the land register, and any VAT are borne by the buyer. The sales commission is the responsibility of the seller, who has signed the sales mandate with our agency.

Property ID: LU160001455 - L-1856 Luxembourg-Limpertsberg – Luxembourg-Limpertsberg

## Contact partner

For further information, please contact your contact person:

VON POLL REAL ESTATE Limpertsberg

---

6, avenue Pasteur Limpertsberg  
E-Mail: [limpertsberg@von-poll.com](mailto:limpertsberg@von-poll.com)

*To Disclaimer of von Poll Immobilien GmbH*

---

[www.von-poll.com](http://www.von-poll.com)