

Luxembourg-Gasperich - Cessage gasperich Howald

## Office space for rent

*Property ID: LU881800089\_6*

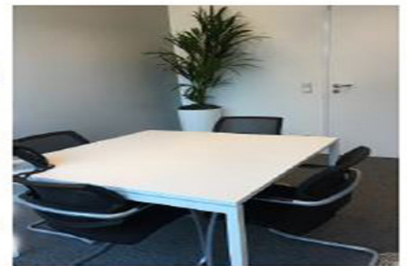
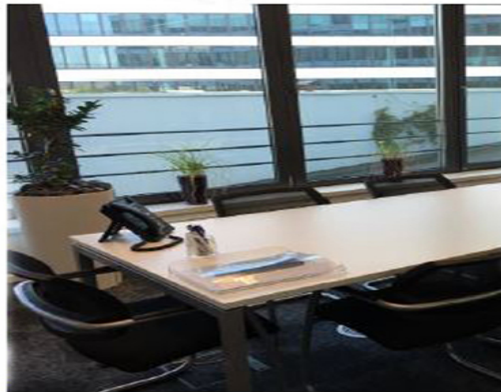

**RENT PRICE: 0 EUR**

**Property ID: LU881800089\_6 - L-1882 Luxembourg-Gasperich - Cessage gasperich  
Howald**

- At a glance
- The property
- Floor plans
- A first impression
- Contact partner

**Property ID: LU881800089\_6 - L-1882 Luxembourg-Gasperich - Cessage gasperich  
Howald**

## At a glance

Property ID	LU881800089_6	Rent price	On request
Available from	04.02.2020	Commission	One month at the expense of the owner.
		Total Space	ca. 13 m <sup>2</sup>

Property ID: LU881800089\_6 - L-1882 Luxembourg-Gasperich - Cessage gasperich  
Howald

## The property

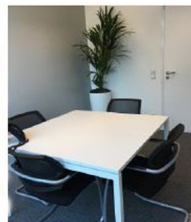
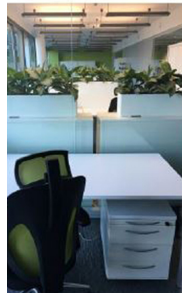

Property ID: LU881800089\_6 - L-1882 Luxembourg-Gasperich - Cessage gasperich  
Howald

## Floor plans

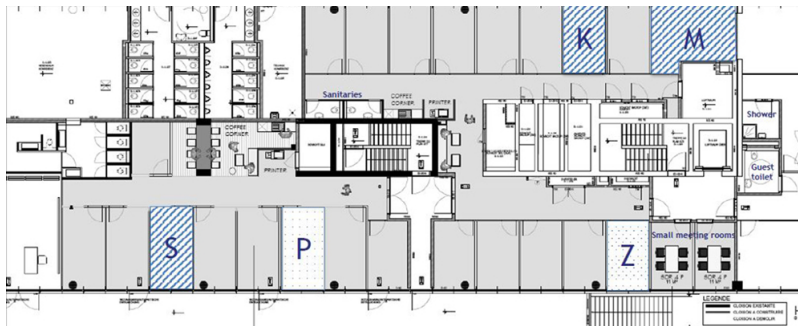
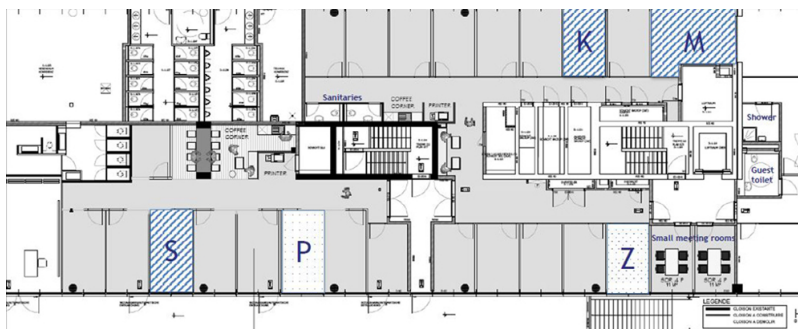

This floor plan is not to scale. The documents were given to us by the client. For this reason, we cannot guarantee the accuracy of the information.

**Property ID: LU881800089\_6 - L-1882 Luxembourg-Gasperich - Cessage gasperich  
Howald**

## A first impression

Beautiful office area fully furnished and equipped. You just have to install and plugger. One part is private and consists of a fully furnished open space and 267 m<sup>2</sup> shared common area (sanitary, kitchen, informal area, reception and meeting room) 4 parking spaces complete the set.

In the same building, a set of closed offices from 13.8 to 19.2 m<sup>2</sup> are for rent all inclusive.

**Property ID: LU881800089\_6 - L-1882 Luxembourg-Gasperich - Cessage gasperich  
Howald**

## Contact partner

For further information, please contact your contact person:

VON POLL REAL ESTATE Limpertsberg

---

6, avenue Pasteur, L-2310 Luxembourg

Tel.: +352 26 47 98

E-Mail: [limpertsberg@von-poll.com](mailto:limpertsberg@von-poll.com)

*To the Disclaimer of von Poll Immobilien GmbH*

---

[www.von-poll.com](http://www.von-poll.com)