

Lorentzweiler

# New accommodation on the top floor of a luxury two-family house on the heights of Lorentzweiler

Property ID: LU221953589\_5



**PURCHASE PRICE: 994.604 EUR • LIVING SPACE: ca. 90,45 m<sup>2</sup>**

**Property ID: LU221953589\_5 - L-7377 Lorentzweiler**

- At a glance**
- The property**
- Energy Data**
- Floor plans**
- A first impression**
- All about the location**
- Other information**
- Contact partner**

Property ID: LU221953589\_5 - L-7377 Lorentzweiler

## At a glance

Property ID	LU221953589_5	Purchase Price	994.604 EUR
Living Space	ca. 90,45 m <sup>2</sup>	Total Space	ca. 117 m <sup>2</sup>
Roof Type	Gabled roof	Condition of property	Projected
Bedrooms	3	Usable Space	ca. 103 m <sup>2</sup>
Bathrooms	1	Equipment	Terrace, Guest WC
Year of construction	2024		
Type of parking	1 x Outdoor parking space, 2 x Multi-storey car park		

Property ID: LU221953589\_5 - L-7377 Lorentzweiler

## Energy Data

Type of heating	Underfloor heating	Energy efficiency class	A
Energy Source	Air-to-water heat pump		
Power Source	Air-to-water heat pump		
Energy information	At the time of preparing the document, no energy certificate was available.		

Property ID: LU221953589\_5 - L-7377 Lorentzweiler

## The property



Property ID: LU221953589\_5 - L-7377 Lorentzweiler

## The property



Property ID: LU221953589\_5 - L-7377 Lorentzweiler

## The property



Property ID: LU221953589\_5 - L-7377 Lorentzweiler

## The property



Property ID: LU221953589\_5 - L-7377 Lorentzweiler

## The property



Property ID: LU221953589\_5 - L-7377 Lorentzweiler

## The property



Property ID: LU221953589\_5 - L-7377 Lorentzweiler

## The property



Property ID: LU221953589\_5 - L-7377 Lorentzweiler

## Floor plans



Les plans sont fournis à titre d'information et ne sont pas contractuels



COMBLES

Les plans sont fournis à titre d'information et ne sont pas contractuels

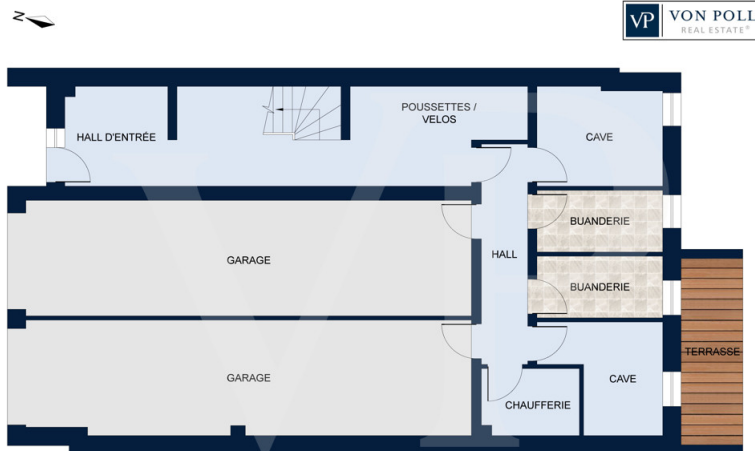

REZ-DE-CHAUSSEE

Les plans sont fournis à titre d'information et ne sont pas contractuels

MAISON BIFAMILIALE - APPARTEMENT N°2 96.45 M<sup>2</sup>

REZ-DE-CHAUSSEE

COMBLES



This floor plan is not to scale. The documents were given to us by the client. For this reason, we cannot guarantee the accuracy of the information.

**Property ID: LU221953589\_5 - L-7377 Lorentzweiler**

## **A first impression**

**Luxury apartment in a two-family house on the heights of Lorentzweiler**

**Located on the heights of Lorentzweiler and facing south, this luxury two-family house sold off-plan is ideal for a family wishing to create their own project in a quiet and green area.**

**Combining modernity and comfort, this luxurious accommodation offers open spaces that can be converted as well as high quality services.**

**The purchaser will be able to define his fittings\* and a wide range of materials will be offered for both floor coverings and bathrooms, etc.**

**A large living room welcomes the dining room and the space for the open kitchen with storage room.**

**The terrace of + - 7,20 m<sup>2</sup> is facing south and another private terrace, accessible from your private cellar leads you to the private garden in which you will enjoy your summer evenings in a cozy and calm atmosphere.**

**At the technical level, the two-family house will have:**

- A heat pump**
- Underfloor heating**
- Triple glazed frames**
- Solar panels to produce hot water**
- Double flow ventilation**
- Power supply for car charger in the garage**

**The sale price includes housing VAT of 3% already considered and subject to acceptance of the purchaser's file for the administration.**

**The accommodation is sold with a garage for 2 cars, a cellar and a private laundry room.**

**\*Possible supplements to be defined with the promoter**

**Property ID: LU221953589\_5 - L-7377 Lorentzweiler**

## **All about the location**

**Located in the North-East of the city of Luxembourg, the municipality of Lorentzweiler is ideally placed to welcome a family wishing to settle in a house in a quiet residential area.**

**The surrounding green areas and the infrastructure of the town allow a multitude of activities around the house.**

**Lorentzweiler is located in the admission area for the European School of Kirchberg and the train station leads you to Pfaffenthal-Kirchberg station in 13 minutes.**

**The Walferdange shopping centre is 4.5 km away.**

**The city of Luxembourg is 8 km away**

**The airport is 14 km away**

**Property ID: LU221953589\_5 - L-7377 Lorentzweiler**

## **Other information**

**All indications in the present document are based exclusively on the information made available to us by our customers. We do not assume any guarantee as to the completeness, accuracy and timeliness of these indications.**

**The notary fees and registration fees in the land register are borne by the buyer.**

**The sales commission is the responsibility of the seller, who has signed the sales mandate with our agency.**

**Property ID: LU221953589\_5 - L-7377 Lorentzweiler**

## Contact partner

**For further information, please contact your contact person:**

**VON POLL REAL ESTATE Limpertsberg**

---

**6, avenue Pasteur, L-2310 Luxembourg**

**Tel.: +352 26 47 98**

**E-Mail: [limpertsberg@von-poll.com](mailto:limpertsberg@von-poll.com)**

*To the Disclaimer of von Poll Immobilien GmbH*

---

**[www.von-poll.com](http://www.von-poll.com)**