

Leudelange - Lux périphérie Sud

## Beautiful office surfaces for rent

*Property ID: LU881800079*



**RENT PRICE: 0 EUR**

**Property ID: LU881800079 - L-3364 Leudelange - Lux périphérie Sud**

- **At a glance**
- **The property**
- **Floor plans**
- **A first impression**
- **Contact partner**

**Property ID: LU881800079 - L-3364 Leudelange - Lux périphérie Sud**

## At a glance

<b>Property ID</b>	<b>LU881800079</b>	<b>Rent price</b>	<b>On request</b>
<b>Available from</b>	<b>04.02.2020</b>	<b>Office/Professional practice</b>	<b>Office centre</b>
		<b>Commission</b>	<b>Fees charged to the owner</b>
		<b>Total Space</b>	<b>ca. 1.202 m<sup>2</sup></b>
		<b>Office space</b>	<b>ca. 1202 m<sup>2</sup></b>
		<b>Equipment</b>	<b>Terrace</b>

Property ID: LU881800079 - L-3364 Leudelange - Lux périphérie Sud

## The property



Property ID: LU881800079 - L-3364 Leudelange - Lux périphérie Sud

## The property



Property ID: LU881800079 - L-3364 Leudelange - Lux périphérie Sud

## The property



Property ID: LU881800079 - L-3364 Leudelange - Lux périphérie Sud

## The property



Property ID: LU881800079 - L-3364 Leudelange - Lux périphérie Sud

## Floor plans

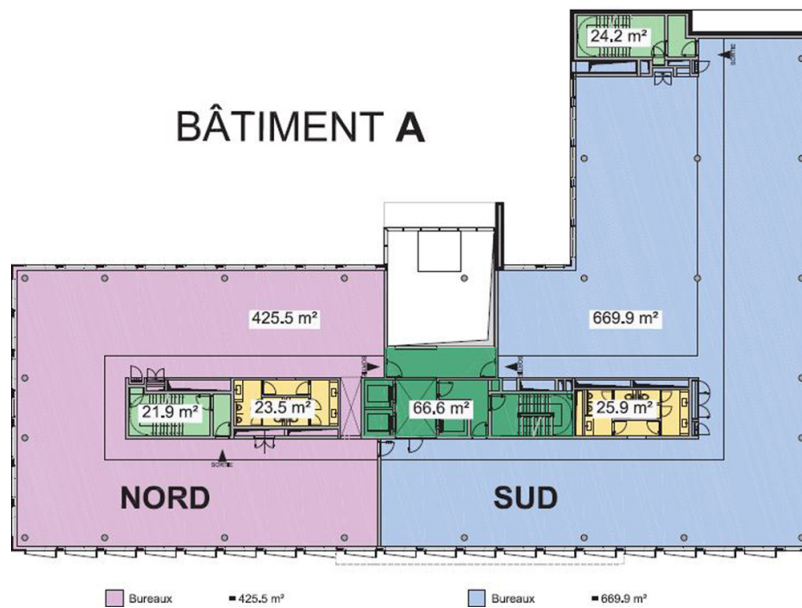

This floor plan is not to scale. The documents were given to us by the client. For this reason, we cannot guarantee the accuracy of the information.

**Property ID: LU881800079 - L-3364 Leudelange - Lux périphérie Sud**

## **A first impression**

Close to public transport and with direct motorway accessibility, the ALTITUDE project is the ideal situation for companies for which mobility, comfort and economy are fundamental criteria for their expansion. The building delivers very nice services and the materials are of high quality.

All the amenities are nearby (nurseries, restaurant, fitness area, ...)

Property ID: LU881800079 - L-3364 Leudelange - Lux périphérie Sud

## Contact partner

For further information, please contact your contact person:

VON POLL REAL ESTATE Limpertsberg

---

6, avenue Pasteur, L-2310 Luxembourg

**Tel.:** +352 26 47 98

**E-Mail:** [limpertsberg@von-poll.com](mailto:limpertsberg@von-poll.com)

*To the Disclaimer of von Poll Immobilien GmbH*

---

[www.von-poll.com](http://www.von-poll.com)